

**ADELAIDE HILLS COUNCIL
ORDINARY COUNCIL MEETING
Tuesday 27 August 2019
AGENDA BUSINESS ITEM**

RELEASED 22 OCTOBER 2019

Item: 19.2

Originating Officer: Ashley Curtis, Manager Civil Services

Responsible Director: Peter Bice, Director Infrastructure & Operations

Subject: Roundabout Landscaping Upgrade

For: Decision

1. Roundabout Landscaping Upgrade– Exclusion of the Public

Pursuant to section 90(2) of the *Local Government Act 1999* the Council orders that all members of the public, except:

- CEO, Andrew Aitken
- Director Infrastructure & Operations, Peter Bice
- Director Development & Regulatory Services, Marc Salver
- Director Corporate Services, Terry Crackett
- Director Community Capacity, David Waters
- Executive Manager Governance & Performance, Lachlan Miller
- Manager Civil Services, Ashley Curtis
- Governance & Risk Coordinator, Steven Watson
- Minute Secretary, Pam Williams

be excluded from attendance at the meeting for Agenda Item 19.1 Road Shoulder Renewal Contract in confidence.

The Council is satisfied that it is necessary that the public, with the exception of Council staff in attendance as specified above, be excluded to enable Council to consider the report at the meeting on the following grounds:

Section 90(3) (d) of the *Local Government Act 1999*, that the information to be received, discussed or considered in relation to this Agenda Item is commercial information of a confidential nature (not being a trade secret) the disclosure of which could reasonably be expected to prejudice the commercial position of the person/agency/business who supplied the information by disclosing specific quotes and modelling by the tenderer.

Accordingly, on this basis the principle that meetings of the Council should be conducted in a place open to the public has been outweighed by the need to keep the information and discussion confidential.

SUMMARY

As part of the 2018/19 Annual Business Plan and Budget, Council approved \$120,000 for landscaping upgrades to roundabouts throughout the Council region. A design for four roundabouts was completed at a cost of approximately \$7,000 with the remaining \$113,000 construction budget proposed to be carried forward to the 2019/20 financial year.

Council staff seek to engage a suitably qualified landscaping contractor to undertake the documented works, and have approached the market via an open tender process. This process resulted in ten submissions, with Plotworks being the preferred tenderer.

All submissions received exceeded the allocated budget when considering the cost of landscaping upgrades to four roundabouts. However there are number of options for Council to consider, ranging from increasing the budget to cover the additional cost, through to upgrading one or two roundabouts only, as well as savings from further reduction in scope.

RECOMMENDATION

Council resolves:

- 1. That the report be received and noted**
- 2. That the capital budget for roundabout landscaping upgrades be increased from \$113,000 to \$167,00**
- 3. To enter into a contract with Plotworks for the provision of landscaping services**
- 4. That roundabout landscaping upgrade works at the Crafers Off Ramp and Verdun sites are undertaken this financial year,**
- 5. That roundabout landscaping upgrade works at the Crafers On Ramp and Piccadilly sites are subject to a future budget.**

1. GOVERNANCE

➤ Strategic Management Plan/Council Policy

Goal 3 Places for People and Nature
Strategy 3.5 We will take a proactive approach, and a long term view, to
 infrastructure maintenance and renewal.

➤ Legal Implications

Necessary approvals are required from key Agencies such as SA Water, and the Department of Planning, Transport and Infrastructure (DPTI).

➤ **Risk Management Implications**

The roundabout landscaping upgrades proposed will assist in mitigating the risk of:

Poor perception of local ammentiy by residents and tourists, leading to reputational damage to Council

Inherent Risk	Residual Risk	Target Risk
Medium (3C)	Low (1C)	Low (1C)

➤ **Financial and Resource Implications**

A budget of \$120,000 was allocated in 2018/19 for the landscaping of roundabouts within the Adelaide Hills Council area. Approximately \$7,000 was spent on survey and design costs in 2018/19, with the balance of \$113,000 proposed to be carried forward into the 2019/20 FY.

➤ **Customer Service and Community/Cultural Implications**

There is a strong desire for the proposed roundabouts to be constructed as soon as possible.

➤ **Environmental Implications**

Environmental design in terms of appropriate species selection for plantings, water utilisation, and drainage have been factored into the designs.

➤ **Engagement/Consultation conducted with Council Committee, Regional Subsidiary, Advisory Group, the Administration and Community**

Consultation on the development of this report was as follows:

Council Committees: Not applicable

Council Workshops: An earlier workshop helped frame the design elements which were put out to tender.

Advisory Groups: Not Applicable

Administration: Chief Executive Officer
Director Infrastructure and Operations
Manager Civil Services
Manager Open Space
Civil Projects Coordinator
Procurement Project Officer

Community: Not applicable

2. BACKGROUND

There has been a strong desire from Council and the community to have a number of key roundabouts landscaped and developed to improve the amenity for locals and tourists who enter and exit the Adelaide Hills.

Roundabouts that we are looking to develop at this stage include Crafers (2), Piccadilly and Verdun. These are key locations with exit and entry linked with the South Eastern Freeway, and thus have an important role to play in providing a welcoming amenity to visitors to the area.

Council engaged landscape architects in early 2018 to provide designs for a number of roundabouts. Following some modifications as a result of discussions with Council Members at a workshop in mid-2018, an open tender for construction released in November 2018, but unfortunately was not successful in attracting any submissions from the market.

Council staff subsequently selected three established landscape construction companies which had previously downloaded the tender documentation and signalled willingness to provide a quote based on value management, i.e. simplifying the design and constructability while achieving a similar 'look and feel'.

These quotes, even with a reduced scope, were well outside the approved budget to undertake the works. It was then decided to re-scope the roundabouts' design and achieve a simplified landscaped design with plantings that would capture the character of the area, e.g. considering seasonal colours. A local landscape architect was engaged to provide this landscape and irrigation design for the roundabouts.

The revised design was presented to Council at a workshop in June 2019. Following minor amendments based on Council's feedback, the design was then presented to DPTI for approval. DPTI is the approving authority as the roundabouts are on roads that come under their care and control. DPTI required some clarifications and amendments, with the main change being the removal of the proposed tree from the Crafers On Ramp roundabout, due to sight line distance.

Following DPTI approval of the amended designs, a set of 'For Tender' designs was prepared and tenders were sought via open tender process in July 2019. Tenders closed on 16th August 2019 with ten submissions received.

3. ANALYSIS

The ten submissions that were received were assessed by a tender assessment panel comprising subject matter experts drawn from staff. Please refer to **Appendix 2** for the Tender Evaluation Summary, noting that due to commercial in confidence, all tenderers (bar the one preferred tenderer) have been de-identified.

Plotworks was identified as the preferred tenderer, due to their competitive rates, experience in delivering similar roundabout landscaping projects, and value add associated with being a local supplier (Mylor). The cost break down of their submission is as follows:

- Crafers On Ramp = \$87,520
- Crafers Off Ramp = \$72,500
- Piccadilly = \$66,277
- Verdun = \$84,118
- Total cost if engaged to complete all four roundabouts = \$279,374 (which represents a discount of \$31,042)

In addition, Council is awaiting final quotes from SA Water for the provision of water meters at these locations. Based on SA Water's indicative fee structure, new connections are expected to cost approximately \$5,000 per site. Accordingly, a Provisional Cost Sum of \$20,000 will need to be allowed for, bringing the total cost for four roundabouts to \$299,374.

Based on the current budget of \$113,000 landscaping works cannot be completed at all four roundabouts.

The current designs include stabilised aggregate to medians and verges surrounding the roundabouts, for aesthetic purposes. Additional savings can be realised by excluding these from the scope of works and focusing on the roundabouts only. By applying these savings, Plotworks' quote is reduced as follows:

- Crafers On Ramp = \$62,740
- Crafers Off Ramp = \$58,020
- Piccadilly = \$55,835
- Verdun = \$84,118

Staff will seek additional savings during negotiations with the preferred supplier.

4. OPTIONS

Council has the following options:

- I. Increase the capital budget from \$113,000 to \$167,000, and undertake landscaping works at Crafers Off Ramp and Verdun. This is the recommended option as Crafers Off Ramp and Verdun are the two roundabouts that have been the subject of the most requests for landscaping upgrades. Works at Crafers On Ramp and Piccadilly could then be budgeted for in a future financial year. (Recommended)
- II. Increase the capital budget from \$113,000 to \$152,500, and undertake landscaping works at Crafers Off Ramp and Verdun, excluding compacted aggregate median and verge treatment. Works at Crafers On Ramp and Piccadilly could then be budgeted for in a future financial year. (Not Recommended)
- III. Increase the capital budget from \$113,000 to \$299,500 and undertake landscaping works at all four roundabouts this financial year. This approach has the benefit of delivering the full design visions at each site now, as well as taking advantage of the

\$31,042 discount offered by Plotworks to do all four roundabouts as one package of works. The drawback of this approach is that it requires a substantial increase in allocated budget. (Not Recommended)

- IV. Do not increase the current budget of \$113,000 and select one roundabout only to landscape this financial year, with the other three to be budgeted for in future financial years. The benefit of this approach is that it does not put any additional pressure on Council's capital budget allocation, but the drawback is that it will be slower to deliver the expected outcomes on the ground.(Not Recommended)

5. APPENDICES

- (1) Roundabout Upgrades Detailed Designs
- (2) Tender Evaluation Summary

Appendix 1

Roundabout Upgrades Detailed Designs

ADELAIDE HILLS COUNCIL ROUNABOUT UPGRADES

LANDSCAPE DRAWINGS TENDER ISSUE - T1

DRAWINGS

NO.	TITLE	REVISION
LP-00	COVER SHEET	T1
LP-01	LANDSCAPE PLAN - CRAFERS ON RAMP	T1
LP-02	LANDSCAPE PLAN - CRAFERS OFF RAMP	T1
LP-03	LANDSCAPE PLAN - PICCADILLY	T1
LP-04	LANDSCAPE PLAN - VERDUN	T1
LP-05	DETAILS	T1

PLANT SCHEDULE

CODE	SPECIES	SIZE	HT x SP	LP-01	LP-02	LP-03	LP-04	TOTAL
TREES								
ACE 'JR'	ACER freemanii 'Jeffers Red'	45L	13m x 10m				3	3
SHRUBS AND GROUNDCOVERS								
ACA bai	ACACIA baileyana Prostrate	140mm	0.6m x 2m	100	85		110	295
CAL GJ	CALLISTEMON viminalis 'Green John'	140mm	0.6m x 1m				140	140
DIA bre	DIANELLA 'Breeze'	140mm	0.6m x 0.6m	60		100	50	210
LOM tan	LOMANDRA 'Tanika'	140mm	0.6m x 0.6m	50			150	200
NAN 'GS'	NANDINA 'Gulf Stream'	140mm	0.5m x 0.5m		60		150	210
RAP 'SM'	RAPHIOLEPSIS 'Snow Maiden'	140mm	0.75m x 0.5m		30			30
ROS 'HC'	ROSMARINUS 'Huntington Carpet'	140mm	0.3m x 2m			150		150
ROS off	ROSMARINUS officinalis	140mm	1.2m x 1.2m			150		150
WES 'GB'	WESTRINGIA 'Grey Box'	140mm	0.65m x 0.9m	70	100	80	140	390
WES mun	WESTRINGIA 'Mundi'	140mm	0.5m x 1.5m	60	70	45	140	315

REVISIONS

No.	DESCRIPTION	BY	DATE
A	FOR REVIEW	CL	10/07/19
T1	TENDER ISSUE	CL	18/07/19

CLIENT

ADELAIDE HILLS COUNCIL

PROJECT

ROUNABOUT UPGRADES

ADDRESS

ADELAIDE HILLS

DRAWING TITLE



COVERSHEET

SCALE

10.07.19

PROJECT NUMBER	DRAWING NUMBER	REVISION
CL19-13	LP-00	T1

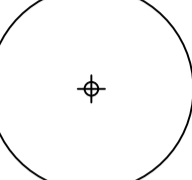
LEGEND

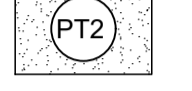
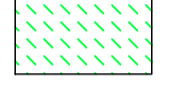
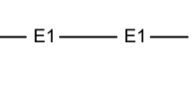
-  PROPOSED TREE
-  PAVEMENT TYPE 1 - STABILISED AGGREGATE: STONYFELL QUARRY SAND
-  PAVEMENT TYPE 2 - STABILISED AGGREGATE: DOLOMITE
-  PLANTING AREA AS SPECIFIED
-  EDGE TYPE 1 - STEEL EDGE AS SPECIFIED

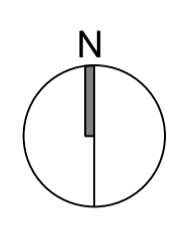

2 LANDSCAPE PLAN
SCALE 1:100 @ A1

PLANT SCHEDULE

CODE	SPECIES	SIZE	HT x SP	LP-01
TREES				
ACE 'JR'	ACER freemanii 'Jeffers Red'	45L	13m x 10m	
SHRUBS AND GROUNDCOVERS				
ACA bai	ACACIA baileyana Prostrate	140mm	0.6m x 2m	100
CAL GJ	CALLISTEMON viminalis 'Green John'	140mm	0.6m x 1m	
DIA bre	DIANELLA 'Breeze'	140mm	0.6m x 0.6m	60
LOM tan	LOMANDRA 'Tanika'	140mm	0.6m x 0.6m	50
NAN 'GS'	NANDINA 'Gulf Stream'	140mm	0.5m x 0.5m	
RAP 'SM'	RAPHIOLEPSIS 'Snow Maiden'	140mm	0.75m x 0.5m	
ROS 'HC'	ROSMARINUS 'Huntington Carpet'	140mm	0.3m x 2m	
ROS off	ROSMARINUS officinalis	140mm	1.2m x 1.2m	
WES 'GB'	WESTRINGIA 'Grey Box'	140mm	0.65m x 0.9m	70
WES mun	WESTRINGIA 'Mundi'	140mm	0.5m x 1.5m	60

REVISIONS			
No.	DESCRIPTION	BY	DATE
A	FOR REVIEW	CL	10/07/19
T1	TENDER ISSUE	CL	18/07/19

CLIENT
ADELAIDE HILLS COUNCIL

PROJECT
ROUNDBOUT UPGRADES

ADDRESS
CRAFERS ON RAMP - WAVERLEY RIDGE RD STH

DRAWING TITLE
LANDSCAPE PLAN

SCALE
1:100 @ A1

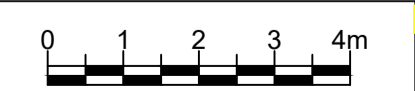

DATE
10.07.19

PROJECT NUMBER	DRAWING NUMBER	REVISION
CL19-13	LP-01	T1

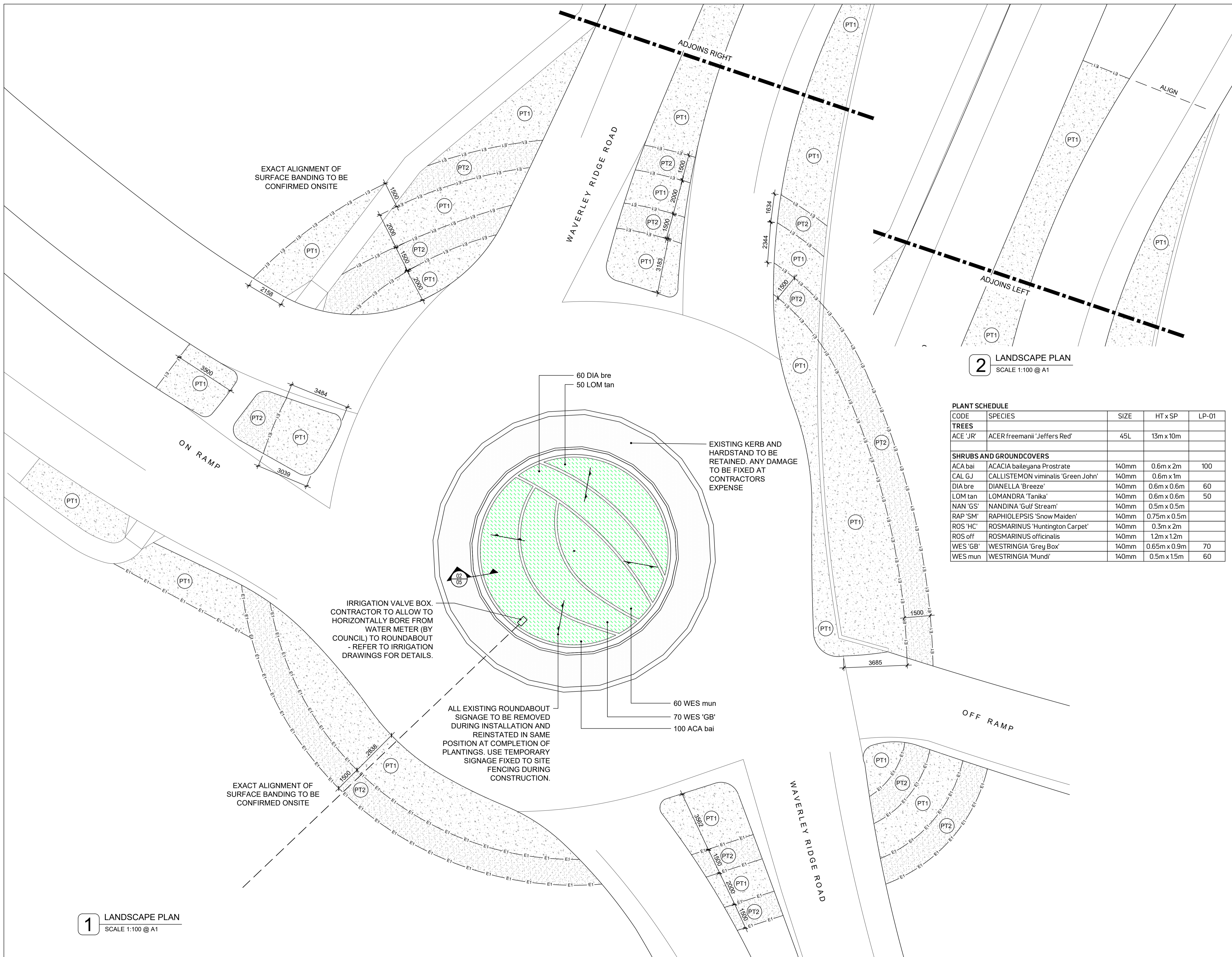

1 LANDSCAPE PLAN
SCALE 1:100 @ A1

PLANT SCHEDULE

CODE	SPECIES	SIZE	HT x SP	LP-02
TREES				
ACE 'JR'	ACER freemanii 'Jeffers Red'	45L	13m x 10m	
SHRUBS AND GROUNDCOVERS				
ACA bai	ACACIA baileyana Prostrate	140mm	0.6m x 2m	85
CAL GJ	CALLISTEMON viminalis 'Green John'	140mm	0.6m x 1m	
DIA bre	DIANELLA 'Breeze'	140mm	0.6m x 0.6m	
LOM tan	LOMANDRA 'Tanika'	140mm	0.6m x 0.6m	
NAN 'GS'	NANDINA 'Gulf Stream'	140mm	0.5m x 0.5m	60
RAP 'SM'	RAPHIOLEPSIS 'Snow Maiden'	140mm	0.75m x 0.5m	30
ROS 'HC'	ROSMARINUS 'Huntington Carpet'	140mm	0.3m x 2m	
ROS off	ROSMARINUS officinalis	140mm	1.2m x 1.2m	
WES 'GB'	WESTRINGIA 'Grey Box'	140mm	0.65m x 0.9m	100
WES mun	WESTRINGIA 'Mundi'	140mm	0.5m x 1.5m	70

LEGEND

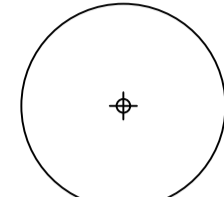
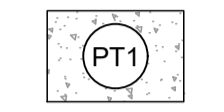
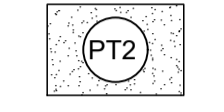
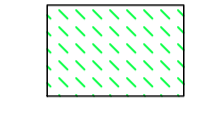
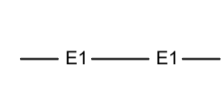
-  PROPOSED TREE
-  PAVEMENT TYPE 1 - STABILISED AGGREGATE: STONYFELL QUARRY SAND
-  PAVEMENT TYPE 2 - STABILISED AGGREGATE: DOLOMITE
-  PLANTING AREA AS SPECIFIED
-  EDGE TYPE 1 - STEEL EDGE AS SPECIFIED

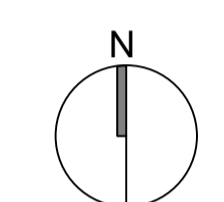

REVISIONS			
No.	DESCRIPTION	BY	DATE
A	FOR REVIEW	CL	10/07/19
T1	TENDER ISSUE	CL	15/07/19

CLIENT
ADELAIDE HILLS COUNCIL

PROJECT
ROUNDBOUT UPGRADES

ADDRESS
CRAFERS OFF RAMP - WAVERLEY RIDGE RD NTH

DRAWING TITLE
LANDSCAPE PLAN

SCALE
1:100 @ A1



DATE
10.07.19

PROJECT NUMBER	DRAWING NUMBER	REVISION
CL19-13	LP-02	T1

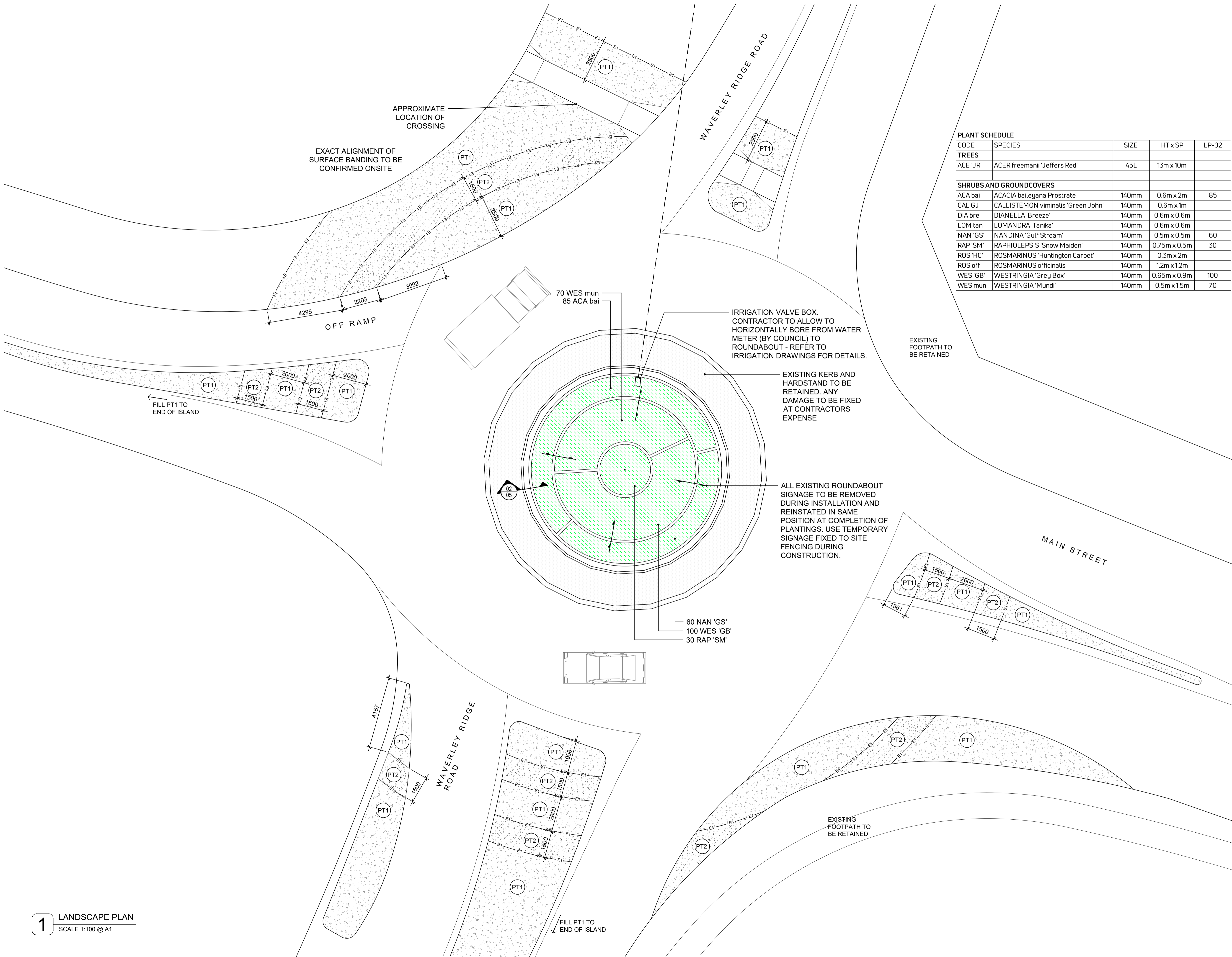

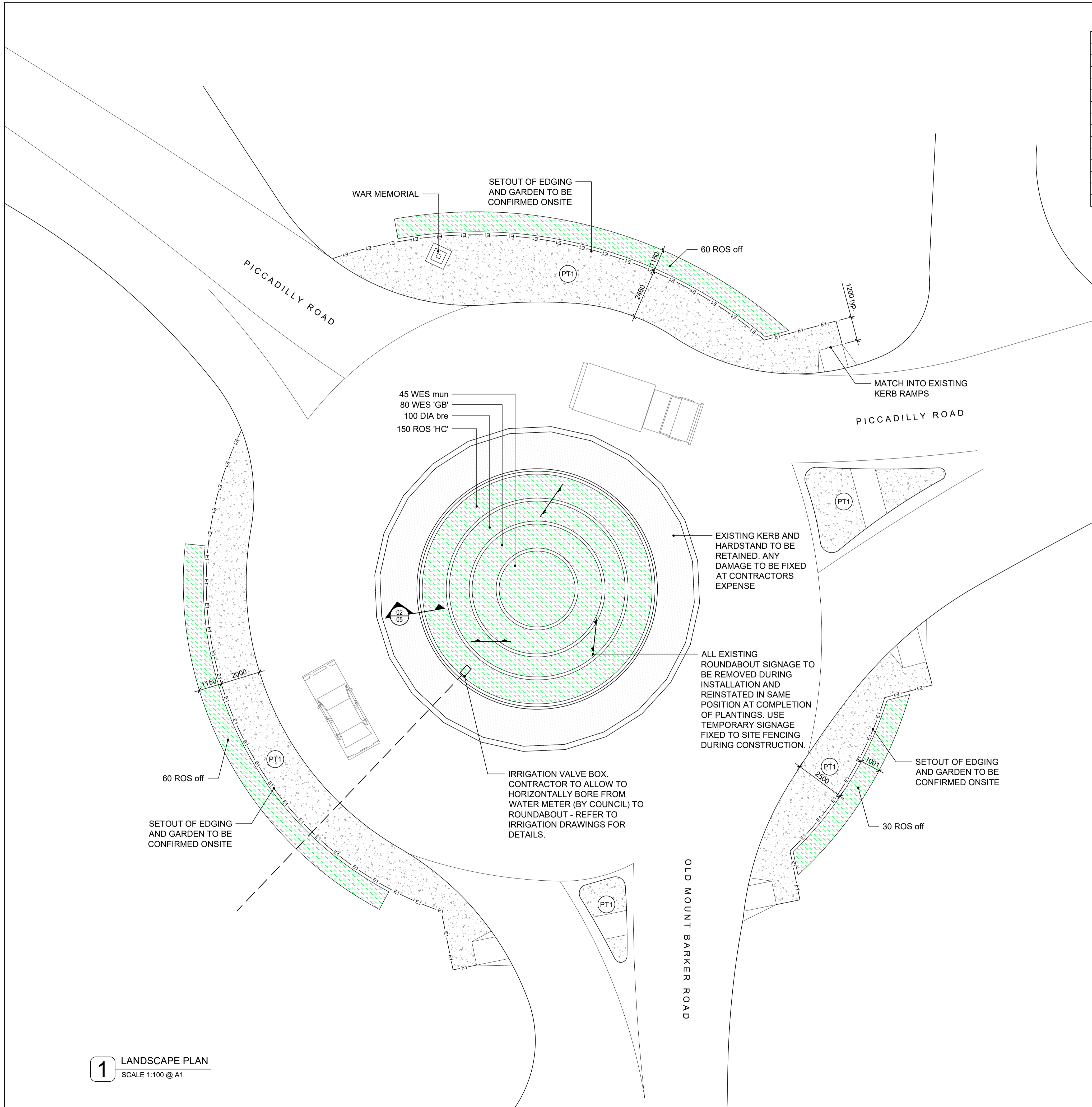

PLANT SCHEDULE

CODE	SPECIES	SIZE	HT x SP	LP-03
TREES				
ACE 'JR'	ACER freemanii 'Jeffers Red'	45L	13m x 10m	
SHRUBS AND GROUNDCOVERS				
ACA bai	ACACIA baileyana Prostrate	140mm	0.6m x 2m	
CAL GJ	CALLISTEMON viminialis 'Green John'	140mm	0.6m x 1m	
DIA bre	DIANELLA 'Breeze'	140mm	0.6m x 0.6m	100
LOM tan	LOMANDRA 'Tanika'	140mm	0.6m x 0.6m	
NAN 'GS'	NANDINA 'Gulf Stream'	140mm	0.5m x 0.5m	
RAP 'SM'	RAPHIOLEPSIS 'Snow Maiden'	140mm	0.75m x 0.5m	
ROS 'HC'	ROSMARINUS 'Huntington Carpet'	140mm	0.3m x 2m	150
ROS off	ROSMARINUS officinalis	140mm	1.2m x 1.2m	150
WES 'GB'	WESTRINGIA 'Grey Box'	140mm	0.65m x 0.9m	80
WES mun	WESTRINGIA 'Mundi'	140mm	0.5m x 1.5m	45

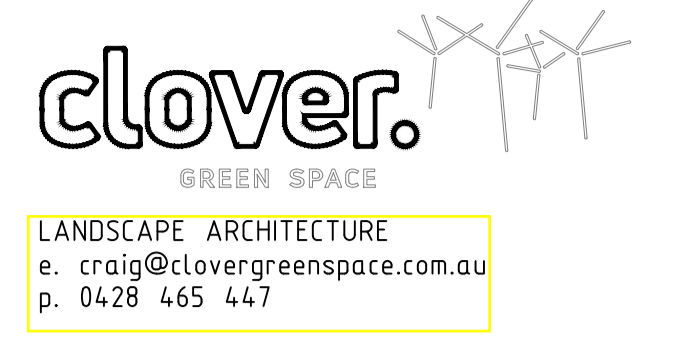

LEGEND

- PROPOSED TREE
- PAVEMENT TYPE 1 - STABILISED AGGREGATE: STONYFELL QUARRY SAND
- PAVEMENT TYPE 2 - STABILISED AGGREGATE: DOLOMITE
- PLANTING AREA AS SPECIFIED
- EDGE TYPE 1 - STEEL EDGE AS SPECIFIED

N

REVISIONS

No.	DESCRIPTION	BY	DATE
A	FOR REVIEW	CL	10/07/19
T1	TENDER ISSUE	CL	18/07/19

CLIENT
ADELAIDE HILLS COUNCIL

PROJECT
ROUNDABOUT UPGRADES

ADDRESS
PICCADILLY - PICCADILLY ROAD / OLD MT BARKER RD

DRAWING TITLE
LANDSCAPE PLAN



SCALE
1:100 @ A1

DATE
10.07.19

PROJECT NUMBER	DRAWING NUMBER	REVISION
CL19-13	LP-03	T1

1 LANDSCAPE PLAN
SCALE 1:100 @ A1

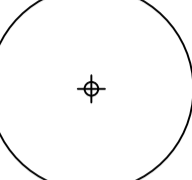
LEGEND

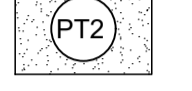
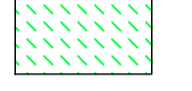
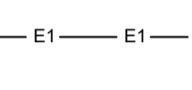
-  PROPOSED TREE
-  PAVEMENT TYPE 1 - STABILISED AGGREGATE: STONYFELL QUARRY SAND
-  PAVEMENT TYPE 2 - STABILISED AGGREGATE: DOLOMITE
-  PLANTING AREA AS SPECIFIED
-  EDGE TYPE 1 - STEEL EDGE AS SPECIFIED

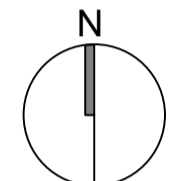

REVISIONS			
No.	DESCRIPTION	BY	DATE
A	FOR REVIEW	CL	10/07/19
T1	TENDER ISSUE	CL	18/07/19

CLIENT
ADELAIDE HILLS COUNCIL

PROJECT
ROUNDBOUT UPGRADES

ADDRESS
VERDUN - ONKAPARINGA VALLEY RD / MT BARKER RD

DRAWING TITLE
LANDSCAPE PLAN

SCALE
1:100 @ A1

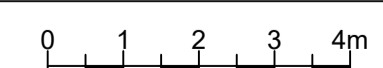

DATE
10.07.19

PROJECT NUMBER	DRAWING NUMBER	REVISION
CL19-13	LP-04	T1

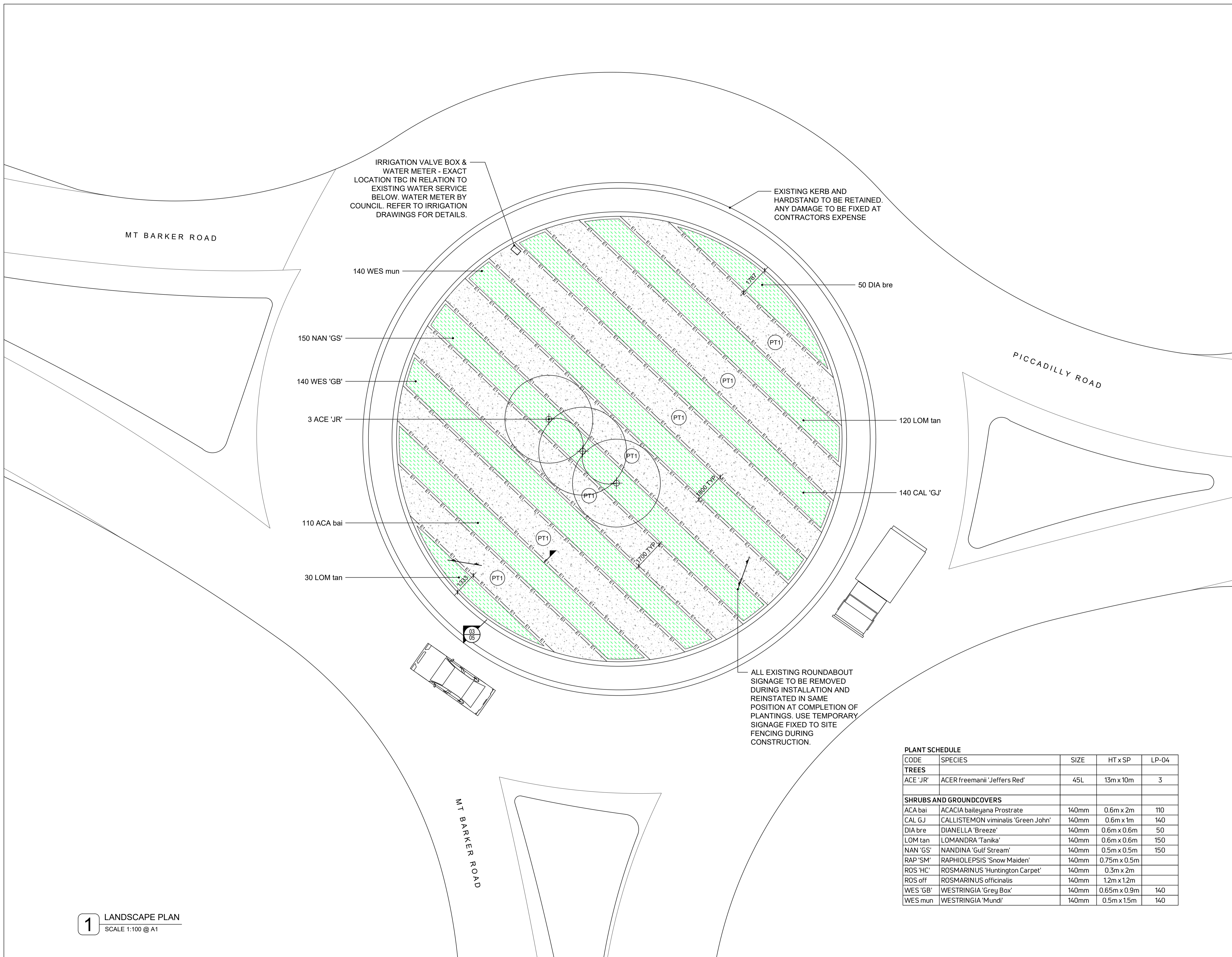

IRRIGATION VALVE BOX & WATER METER - EXACT LOCATION TBC IN RELATION TO EXISTING WATER SERVICE BELOW. WATER METER BY COUNCIL. REFER TO IRRIGATION DRAWINGS FOR DETAILS.

EXISTING KERB AND HARDSTAND TO BE RETAINED. ANY DAMAGE TO BE FIXED AT CONTRACTORS EXPENSE

ALL EXISTING ROUNDABOUT SIGNAGE TO BE REMOVED DURING INSTALLATION AND REINSTATED IN SAME POSITION AT COMPLETION OF PLANTINGS. USE TEMPORARY SIGNAGE FIXED TO SITE FENCING DURING CONSTRUCTION.

PLANT SCHEDULE				
CODE	SPECIES	SIZE	HT x SP	LP-04
TREES				
ACE 'JR'	ACER freemanii 'Jeffers Red'	45L	13m x 10m	3
SHRUBS AND GROUNDCOVERS				
ACA bai	ACACIA baileyana Prostrate	140mm	0.6m x 2m	110
CAL GJ	CALLISTEMON viminalis 'Green John'	140mm	0.6m x 1m	140
DIA bre	DIANELLA 'Breeze'	140mm	0.6m x 0.6m	50
LOM tan	LOMANDRA 'Tanika'	140mm	0.6m x 0.6m	150
NAN 'GS'	NANDINA 'Gulf Stream'	140mm	0.5m x 0.5m	150
RAP 'SM'	RAPHIOLEPSIS 'Snow Maiden'	140mm	0.75m x 0.5m	
ROS 'HC'	ROSMARINUS 'Huntington Carpet'	140mm	0.3m x 2m	
ROS off	ROSMARINUS officinalis	140mm	1.2m x 1.2m	
WES 'GB'	WESTRINGIA 'Grey Box'	140mm	0.65m x 0.9m	140
WES mun	WESTRINGIA 'Mundi'	140mm	0.5m x 1.5m	140

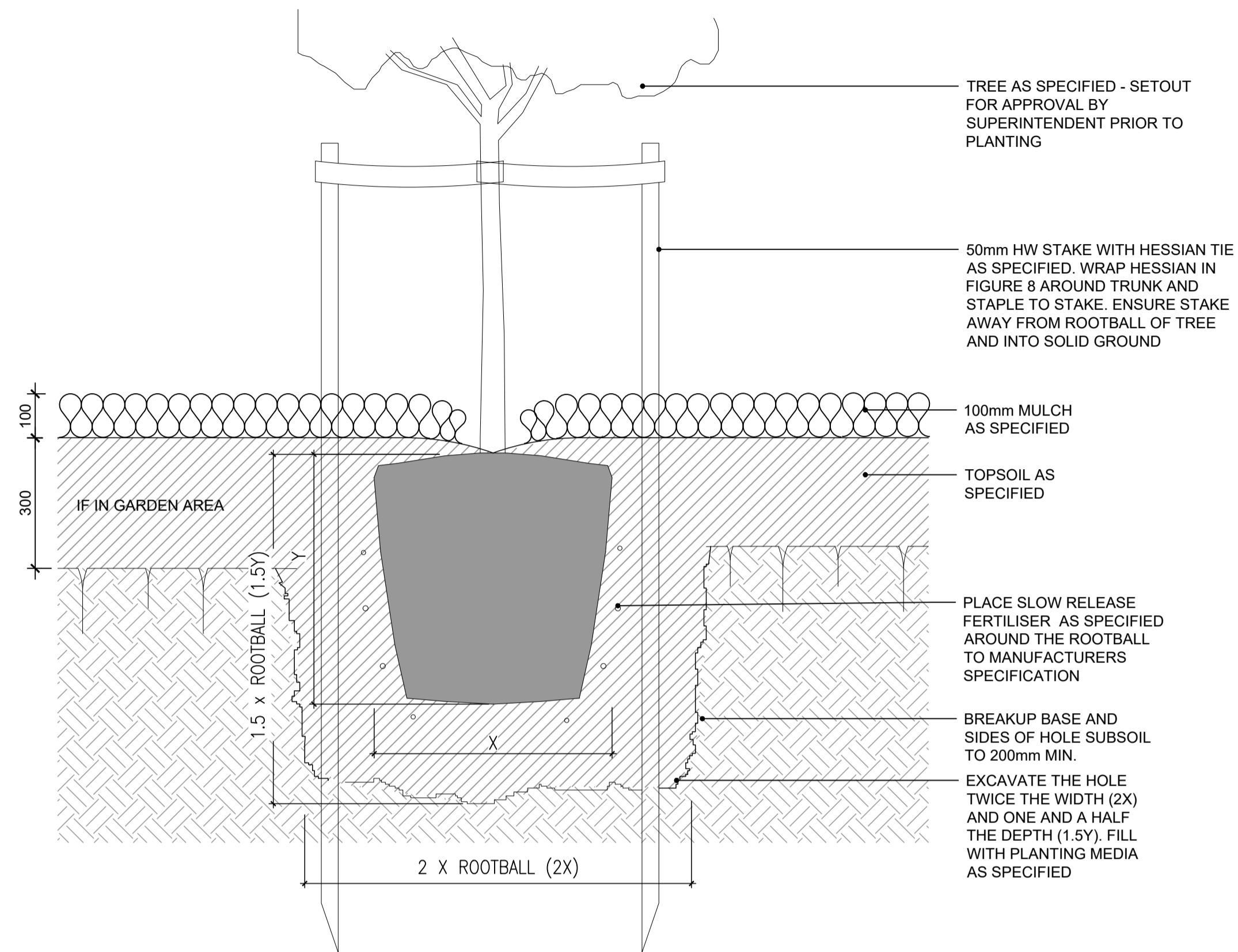

1 SECTION - TREE IN GARDEN
SCALE 1:10 @ A1

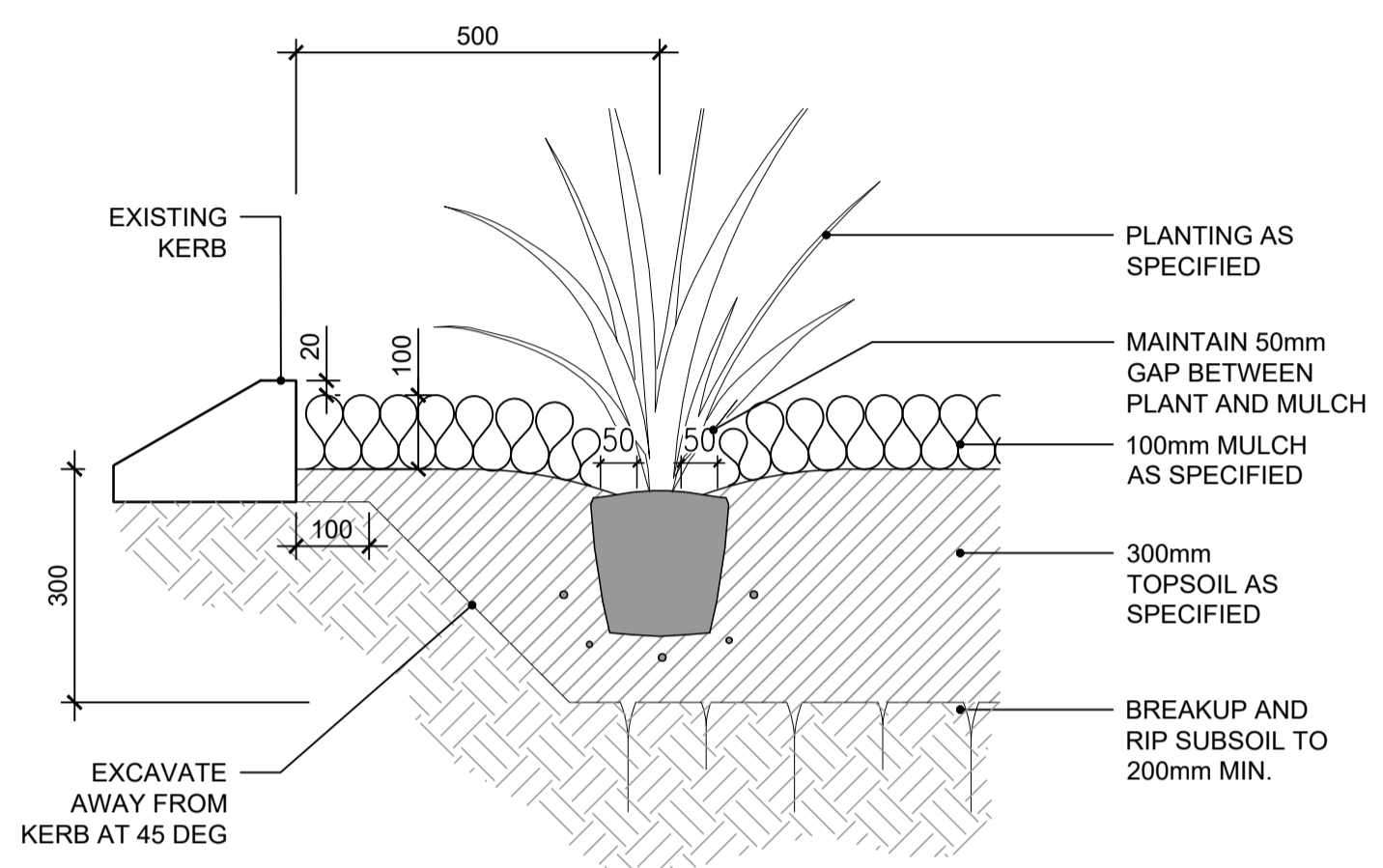

2 SECTION - PLANTING TYP.
SCALE 1:10 @ A1

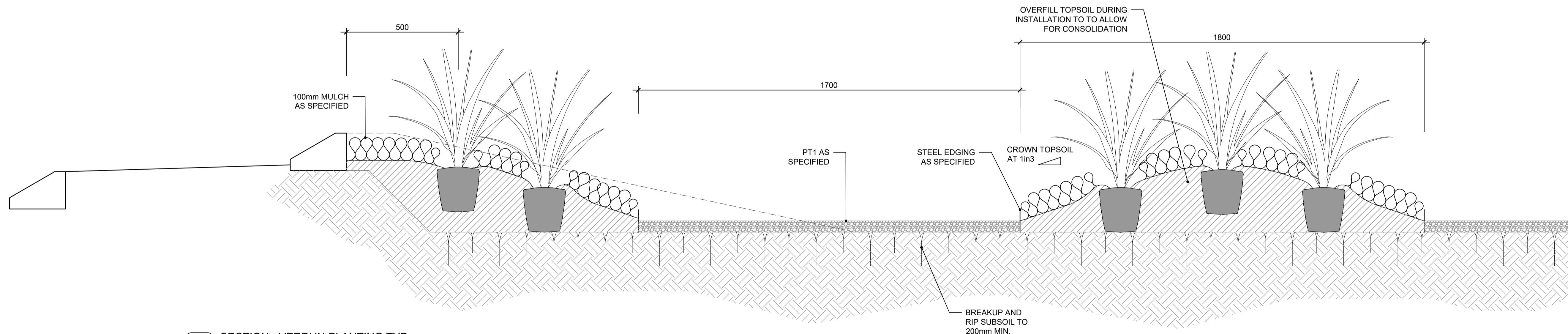

3 SECTION - VERDUN PLANTING TYP.
SCALE 1:10 @ A1

REVISIONS			
No.	DESCRIPTION	BY	DATE
A	FOR REVIEW	CL	10/07/19
T1	TENDER ISSUE	CL	18/07/19

CLIENT
ADELAIDE HILLS COUNCIL

PROJECT
ROUNDBOUT UPGRADES

ADDRESS
ADELAIDE HILLS

DRAWING TITLE
DETAILS

SCALE
1:10 @ A1

DATE
10.07.19

PROJECT NUMBER	DRAWING NUMBER	REVISION
CL19-13	LP-05	T1

Appendix 2

Tender Evaluation Summary

Tender Evaluation Summary

Project Roundabouts Tender
 Project # 3766
 Tender # 01/20
 Date 15/08/2019

DO NOT TYPE ON THIS PAGE

	Tenderer A	Tenderer B	Tenderer C	Tenderer D	Tenderer E	Tenderer F	Tenderer G	Plotworks	Tenderer I	Tenderer J	
Tender Lump Sum Amount (excl. GST)	\$242,684	\$394,292	\$297,956	\$242,006	\$394,278	\$239,083	\$473,770	\$279,374	\$392,338	\$304,000	
<i>Variance from Median</i>	-19%	31%	-1%	-20%	31%	-21%	57%	-7%	30%	1%	
Composition of Tender											
1.1											
1	Crafers On Ramp	\$ 64,368	\$ 106,997	\$ 90,148	\$ 66,402	\$ 106,897	\$ 67,309	\$ 133,529	\$ 87,520	\$ 106,155	\$ 86,440
2	Crafers Off Ramp	\$ 59,772	\$ 89,214	\$ 80,495	\$ 66,317	\$ 86,844	\$ 53,118	\$ 113,770	\$ 72,500	\$ 93,300	\$ 78,557
3	Piccadilly	\$ 47,845	\$ 88,448	\$ 78,807	\$ 50,129	\$ 84,624	\$ 53,292	\$ 107,935	\$ 66,277	\$ 89,027	\$ 69,588
4	Verdun	\$ 74,699	\$ 113,615	\$ 83,212	\$ 63,658	\$ 126,072	\$ 71,031	\$ 118,536	\$ 84,118	\$ 103,857	\$ 77,211
5	Discount	-\$ 4,000	-\$ 3,983	-\$ 34,706	-\$ 4,500	-\$ 10,159	-\$ 5,666		-\$ 31,042		-\$ 7,795
		\$ -	\$ 0	\$ -	\$ -	\$ -	\$ -	\$ -	-\$ 1	\$ -	\$ 0

Evaluation Matrix																					
Analysis Criteria	Weight	Tenderer A		Tenderer B		Tenderer C		Tenderer D		Tenderer E		Tenderer F		Tenderer G		Plotworks		Tenderer I		Tenderer J	
		Weighted	Raw	Weighted	Raw	Weighted	Raw	Weighted	Raw	Weighted	Raw	Weighted	Raw	Weighted	Raw	Weighted	Raw	Weighted	Raw	Weighted	Raw
Price / Value	30%	29.55		18.19		24.07		29.64		18.19		30.00		15.14		25.67		18.28		23.59	
Methodology	20%	10.00	5.00	12.00	6.00	12.00	6.00	9.00	4.50	17.00	8.50	9.00	4.50	12.00	6.00	15.00	7.50	14.00	7.00	15.00	7.50
<i>Ashley Curtis</i>			6.00		5.00		6.00		4.00		9.00		7.00		6.00		8.00		7.00		8.00
<i>Oliver Pfueller</i>			4.00		7.00		6.00		5.00		8.00		2.00		6.00		7.00		7.00		7.00
Program	10%	15.00	7.50	12.00	6.00	14.00	7.00	1.00	0.50	14.00	7.00	14.00	7.00	8.00	4.00	15.00	7.50	1.00	0.50	15.00	7.50
<i>NAME 1</i>			7.00		5.00		7.00		1.00		7.00		7.00		4.00		7.00		1.00		8.00
<i>NAME 2</i>			8.00		7.00		7.00		0.00		7.00		7.00		4.00		8.00		0.00		7.00
Resources	15%	13.00	6.50	10.00	5.00	12.00	6.00	7.00	3.50	16.00	8.00	7.00	3.50	16.00	8.00	14.00	7.00	16.00	8.00	14.00	7.00
<i>NAME 1</i>			8.00		5.00		6.00		5.00		8.00		5.00		8.00		7.00		8.00		7.00
<i>NAME 2</i>			5.00		5.00		6.00		2.00		8.00		2.00		8.00		7.00		8.00		7.00
Experience	15%	11.00	5.50	12.00	6.00	13.00	6.50	7.00	3.50	17.00	8.50	9.00	4.50	10.00	5.00	17.00	8.50	14.00	7.00	17.00	8.50
<i>NAME 1</i>			6.00		7.00		6.00		4.00		9.00		7.00		5.00		8.00		7.00		9.00
<i>NAME 2</i>			5.00		5.00		7.00		3.00		8.00		2.00		5.00		9.00		7.00		8.00
Sustainability	10%	15.00	7.50	10.00	5.00	12.00	6.00	7.00	3.50	12.00	6.00	4.00	2.00	12.00	6.00	15.00	7.50	2.00	1.00	13.00	6.50
<i>NAME 1</i>			8.00		5.00		7.00		1.00		5.00		1.00		6.00		9.00		1.00		8.00
<i>NAME 2</i>			7.00		5.00		5.00		6.00		7.00		3.00		6.00		6.00		1.00		5.00
Total Tender Score	100%	93.55		74.19		87.07		60.64		94.19		73.00		73.14		101.67		65.28		97.59	
Rank		4		6		5		10		3		8		7		1		9		2	
Score w/o Price	70%	54.00		44.00		51.00		22.00		59.00		34.00		46.00		61.00		33.00		59.00	
Rank		4		7		5		10		2		8		6		1		9		2	

2. Roundabout Landscaping Upgrade – Period of Confidentiality

Subject to the CEO, or his delegate, disclosing information or any document (in whole or in part) for the purpose of implementing Council’s decision(s) in this matter in the performance of the duties and responsibilities of office, Council, having considered Agenda Item 19.1 in confidence under sections 90(2) and 90(3)(d) of the *Local Government Act 1999*, resolves that an order be made under the provisions of sections 91(7) and (9) of the *Local Government Act 1999* that the value of the successful tenderer submission be retained in confidence until the contract is entered into.

Pursuant to section 91(9)(c) of the *Local Government Act 1999*, Council delegates the power to revoke the confidentiality order either partially or in full to the Chief Executive Officer.